



Seamless Touch Experience with a Highly Durable Screen for Industrial, Medical, and Other Markets

Projected Capacitive Touch Panel

The DuraVision FDF2382WT and FDS1782T feature projected capacitive (PCAP) touch technology which is more durable and reliable compared to other touch technologies. Both monitors accept touch input from a bare finger or dedicated stylus.



Stylus Compatibility

Both monitors can be used with a touch stylus for smooth writing.

Visit www.eizoglobal.com/it/stylus for compatibility information.

Multitouch Interface

The screen can detect up to 10 simultaneous touches so you can easily operate a variety of applications in almost any environment. Furthermore, compared to 5-point multitouch the screen has a higher touch sensitivity, making writing with a finger or stylus smoother. The monitors are equipped with palm rejection which allows you to rest your hand directly on the screen without causing any unintended touch input.

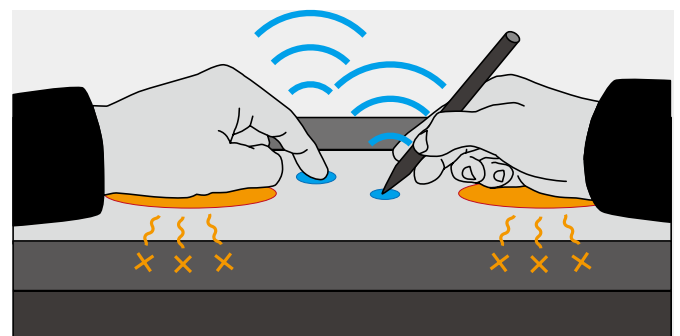

Palm rejection minimum activation area is 2 x 2 cm.

Touch Detection Control

Users can easily turn touch detection on or off by pushing the button conveniently located on the monitor's side.

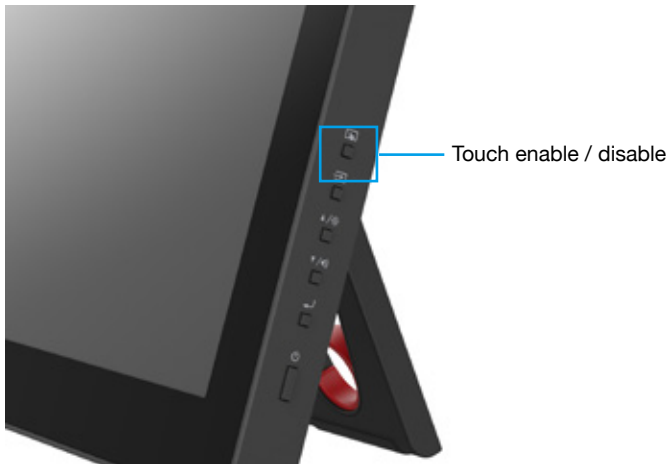

Sensitivity Calibration

The monitors are equipped with technology which calibrates the touch sensitivity to minimize incorrect touch response due to environmental factors and electromagnetic noise. This ensures that the screen maintains accurate touch interaction during use.

Fully Flat Design

The fully flat surface provides a seamless touch experience to the edges of the screen. This makes swiping motions and scrolling a breeze.

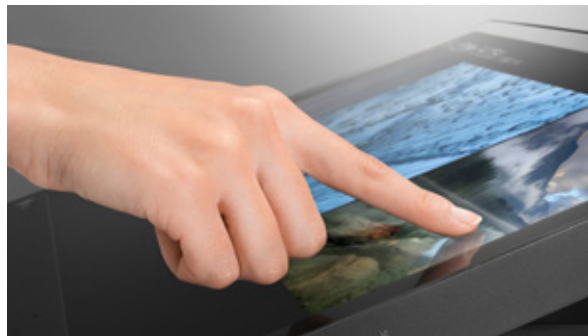

IPS Panel

The monitors use an LED-backlit IPS panel with wide viewing angles that minimize color shift and contrast changes when viewing the screen from the side. The surface of the panel is also coated with an anti-glare treatment for further clarity in bright ambient environments.



High Durability

The touch screen has a non-scratch surface made of reinforced glass with a hardness of 5H (Mohs scale), making it durable enough to withstand long-term use in a range of environments.

Reclining Stand

The equipped stand provides flexible positioning to allow the monitor to rest on your desk like a laptop and recline back to your desired angle. This makes it easy to place the monitor in the ideal position for comfortable use in any environment.

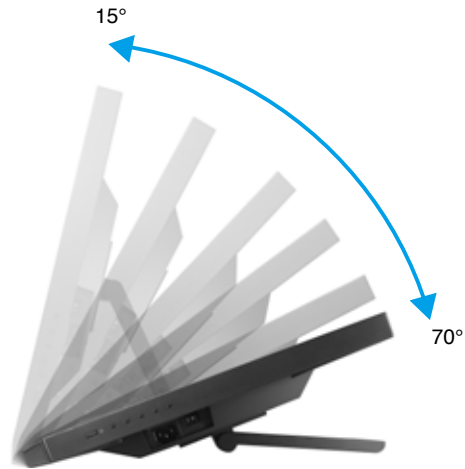

Flicker-Free Viewing

Due to the way brightness is controlled on LED backlights, a small number of people perceive flicker which causes eye fatigue. The DuraVision FDF2382WT relieves eye fatigue by regulating brightness to make flicker unperceivable.



Complete Connection

Both monitors are equipped with DisplayPort, DVI-D, and D-Sub inputs which are conveniently located on the side for easy access.

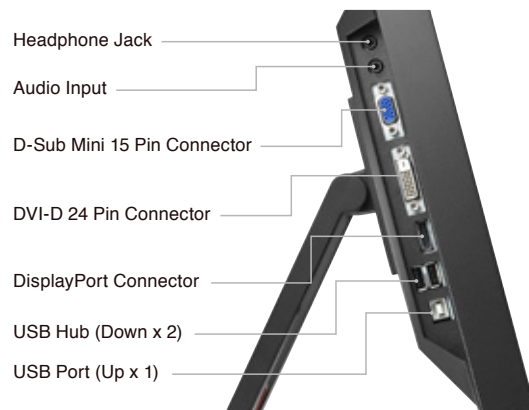

Long-Term Reliability

The monitors are backed by a three year warranty which covers all components to ensure a long service life.

Specifications

FDF2382WT

FDS1782T

| Model Variations | | With Stand, Without Stand | With Stand, Without Stand |
|----------------------------|---|--|--|
| Cabinet Color | | Gray, Black | Gray, Black |
| Panel | Type | IPS | IPS |
| | Backlight | LED | LED |
| | Size | 23" / 58 cm | 17" / 43 cm |
| | Native Resolution | 1920 x 1080 (16:9 aspect ratio) | 1280 x 1024 (5:4 aspect ratio) |
| | Viewable Image Size (H x V) | 509.2 x 286.4 mm | 337.9 x 270.3 mm |
| | Pixel Pitch | 0.265 x 0.265 mm | 0.264 x 0.264 mm |
| | Display Colors | 16.77 million from a palette of 1.06 billion | 16.77 million from a palette of 1.06 billion |
| | Viewing Angles (H / V, typical) | 178°, 178° | 178°, 178° |
| | Brightness (typical) | 260 cd/m ² | 350 cd/m ² |
| | Contrast Ratio (typical) | 1000:1 | 1000:1 |
| Response Time (typical) | 11 ms (gray-to-gray) | 11 ms (gray-to-gray) | |
| Touch Panel | Type | Projected Capacitive | Projected Capacitive |
| | Communication Protocol | USB | USB |
| | Touch Life | 50 million touches (minimum) | 50 million touches (minimum) |
| | Surface Hardness | 5H | 5H |
| | Compatible OS | Windows 10 (64-bit, 32-bit) / Windows 8.1 (64-bit, 32-bit) / Windows 7 (32-bit, 64-bit) | Windows 10 (64-bit, 32-bit) / Windows 8.1 (64-bit, 32-bit) / Windows 7 (32-bit, 64-bit) |
| Video Signals | Input Terminals | D-Sub mini 15 pin x 1, DVI-D 24 pin x 1 (with HDCP), DisplayPort x 1 (with HDCP) | D-Sub mini 15 pin x 1, DVI-D 24 pin x 1 (with HDCP), DisplayPort x 1 (with HDCP) |
| | Digital Scanning Frequency (H / V) | DVI: 31 - 64 kHz, 59 - 61 Hz (VGA Text: 69 - 71 Hz) DisplayPort: 31 - 68 kHz, 59 - 61 Hz (VGA Text: 69 - 71 Hz) | 31 - 64 kHz, 59 - 61 Hz (VGA Text: 69 - 71 Hz) |
| | Analog Scanning Frequency (H / V) | 31 - 81 kHz, 55 - 76 Hz | 31 - 81 kHz, 55 - 76 Hz |
| | Sync Formats | Separate | Separate |
| USB | Function | 1 port for touch panel control | 1 port for touch panel control |
| | Standard | USB 2.0 | USB 2.0 |
| Audio | Speakers | 1.0 W + 1.0 W | 1.0 W + 1.0 W |
| | Input Terminals | 3.5 mm stereo jack | 3.5 mm stereo jack |
| | Output Terminals | 3.5 mm headphone jack | 3.5 mm headphone jack |
| | Sound Adjustment | Volume, Power Save, Source (DisplayPort) | Volume, Power Save, Source (DisplayPort) |
| Power | Power Requirements | AC 100 - 240 V, 50 / 60 Hz | AC 100 - 240 V, 50 / 60 Hz |
| | Maximum Power Consumption | 42 W | 37 W |
| | Typical Power Consumption | 14 W | 10 W |
| | Power Save / Standby Mode | Less than 0.7 W | Less than 0.7 W |
| | Power Management | DVI DMPM, VESA DPM | DVI DMPM, VESA DPM |
| Features & Functions | Preset Modes | Color Mode (User1, User2, sRGB) | Color Mode (User1, User2, sRGB) |
| | Others | Screen Adjustment (Clock, Phase, Position, Range (Auto), Screen Size (full screen, enlarge, normal), Smoothing (5 stages), Border Intensity, Color Adjustment (Brightness, Contrast, Gamma, Temperature, Saturation, Hue, Gain, Overdrive, Reset), Signal Switching, Product Information (name, serial number, resolution, operating time, etc.), OSD Menu Settings, Adjustment Lock, Power Indicator, Reset | Screen Adjustment (Clock, Phase, Position, Range (Auto), Screen Size (full screen, enlarge, normal), Smoothing (5 stages), Border Intensity, Color Adjustment (Brightness, Contrast, Gamma, Temperature, Saturation, Hue, Gain, Overdrive, Reset), Signal Switching, Product Information (name, serial number, resolution, operating time, etc.), OSD Menu Settings, Adjustment Lock, Power Indicator, Reset |
| Physical Specifications | Dimensions (Landscape, W x H x D) | 556.7 x 143.9 - 353.9.7 x 216.3 - 401.3 mm | 391.8 x 142.5 - 348 x 214.9 - 400.4 mm |
| | Dimensions (Without Stand, W x H x D) | 556.7 x 339.2 x 54 mm | 391.8 x 331 x 54 mm |
| | Net Weight | 6.6 kg / 14.5 lbs | 4.8 kg / 10.6 lbs |
| | Net Weight (Without Stand) | 6 kg / 13.2 lbs | 4.3 kg / 9.5 lbs |
| | Tilt | 15° - 70° | 15° - 70° |
| | Hole Spacing (VESA Standard) | 100 x 100 mm | 100 x 100 mm |
| Certifications & Standards | Operating Temperature | 5 - 35 °C | 5 - 35 °C |
| | Operating Humidity (R.H., non condensing) | 20 - 80 % | 20 - 80 % |
| Certifications & Standards | | CB, CE, cTUVus, FCC-B, CAN ICES-3 (B), VCCI-B, BSMI, CCC, RCM, EAC, RoHS, WEEE, China RoHS | CB (IEC60601-1), CB, CE, cTUVus, FCC-B, CAN ICES-3 (B), VCCI-B, BSMI, CCC, RCM, EAC, RoHS, WEEE, China RoHS |
| Supplied Accessories | | AC power cord, signal cables (DVI-D - DVI-D, DisplayPort - DisplayPort), USB cable, audio cable, cleaning cloth, CD-ROM (PDF user's manual, touch panel driver, touch panel calibration software), mask sheet, setup guide | AC power cord, signal cables (DVI-D - DVI-D, DisplayPort - DisplayPort), USB cable, audio cable, cleaning cloth, CD-ROM (PDF user's manual, touch panel driver, touch panel calibration software), mask sheet, setup guide |
| Warranty | | Three Years | Three Years |

Dimensions (Unit: mm)

FDF2382WT

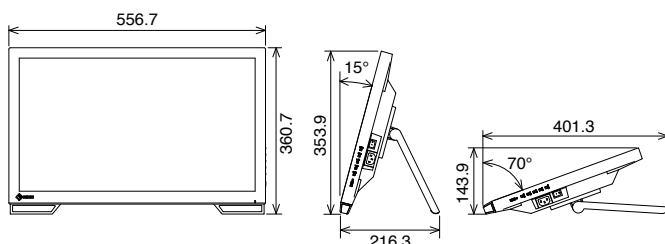

FDS1782T

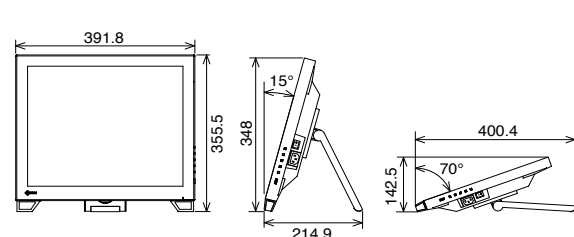

EIZO Corporation

153 Shimokashiwano, Hakusan, Ishikawa 924-8566 Japan

Phone: +81-76-277-6792 Fax: +81-76-277-6793

www.eizoglobal.com

All product names and logos are trademarks or registered trademarks of their respective companies. DuraVision and EIZO are registered trademarks of EIZO Corporation.

Specifications are subject to change without notice.